

Product Information

Switching Head A-V3

For devices VM-



- II 2G Ex d IIC T6

Characteristics

Switching head with pressure-resistant encapsulation and ATEX approval for the VM range of devices.

Technical data

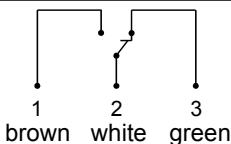
Switch	micro switch
Medium temperature	-20..+90 °C
Ambient temperature	-20..+50 °C
Weight	0.5 kg additionally
Wiring	changeover no. 0.283 
Switching voltage	max. 250 V AC
Switching current	max. 5 A
Protection class	2 - safety insulation
Ingress protection	IP 65
Electrical connection	cable 2.5 m, other cable lengths optionally available

Dimensions

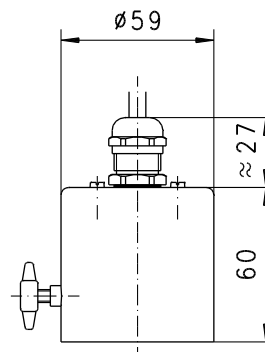

Handling and operation

Note

- Cable lengths max. 5 m.
- It must be ensured that the values given for voltage, current, and power are not exceeded.
- When switched on, a load must be connected in series.
- The electrical details apply to ohmic loads. Capacitive, inductive and lamp loads must be operated using a protective circuit.

Adjustment

To adjust the switching point, the fixing screw for the switching head must be loosened. The switching head can then be rotated. Turning to the right increases the switching point, and vice-versa. Then retighten the fixing screw.

Ordering code

The base device is ordered, e.g. VM-015GR020A with switching head e.g. A-V3-1.

A-V3 - ^{1.} 1

1. Wiring	
1	No. 0.283

Use for devices

Switching head	Device type
A-V3	VM-...

